

PROJECT INFORMATION

APPLICANT:
PETER HOLDEN

DRAWINGS BY:
ECCO DESIGN INC.
7413 GREENWOOD AVE N
SEATTLE, WA 98103
206-706-3937

SITE ADDRESS:
5008 E MERCER WAY
MERCER ISLAND, WA 98040

PARCEL NUMBER:
192405-9247

BODY OF WATER:
LAKE WASHINGTON

LEGAL DESCRIPTION:
BAAP ON S LN OF GL 1 IN NE 1/4 AKA NXN NLY
PROD OF C/L OF BUTTERWORTH RD WITH SD S
LN SD PT LOC S 1295.08 FT & W 72.58 FT FR MDR
COR ON N LN OF SD GL TH NLY ALG CURVE LFT
CTR OF WCH LIES N 68-03-39 W 542.30 FT ARC
DIST 96.42 FT TH N 11-45-07 E 367.31 FT TH N
88-03-30 W 130.44 FT TH N 36-25-12 W 151.36 FT
TO TPOB TH N 88-24-56 W ALG N LN OF S 580.00
FT OF SD GL 84.06 FT TH N 13-28-01 E 122.60 FT
TH S 88-44-44 E ALG N LN OF S 700.00 FT OF SD
GL 173.51 FT TH S 02-38-45 E 91.21 FT TH S
88-24-56 E ALG N LN OF S 610.00 FT OF SD GL TO
SH LN TH SLY TAP S 88-24-56 E OF TPOB TH N
88-24-56 W TO TPOB LESS S 15.00 FT IN WIDTH &
SH LDS ADJ ON E

PROJECT DESCRIPTION:
PERMIT AN EXISTING BOAT LIFT.

VICINITY MAP

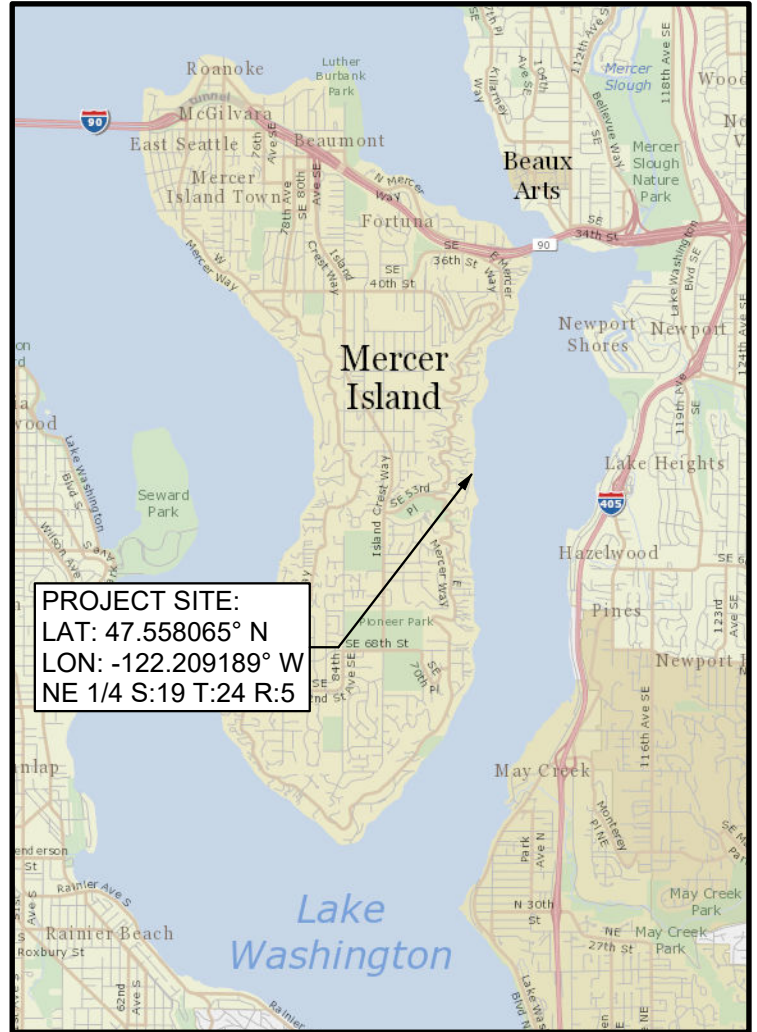

REFERENCE:

DATUM: C.O.E. Locks Datum

ADJACENT PROPERTY OWNERS:

1. Rod Zorotovich
2. Kasey & Kristin Keller

APPLICANT: Peter Holden

LOCATION: 5008 E Mercer Way
Mercer Island, WA 98040

LAT/LONG: 47.558065°/-122.209189°

PROPOSED PROJECT:

Boat Lift
IN: Lake Washington
NEAR/AT: Mercer Island
COUNTY: King **STATE:** WA

SHEET 1 of 4

DATE: March 19, 2026

PLEASE NOTE THAT THE SHORELINE CONFIGURATION AND PROPERTY LINE LOCATIONS ARE APPROXIMATE ONLY. PROPERTY LINES ARE BASED ON KING COUNTY GIS.

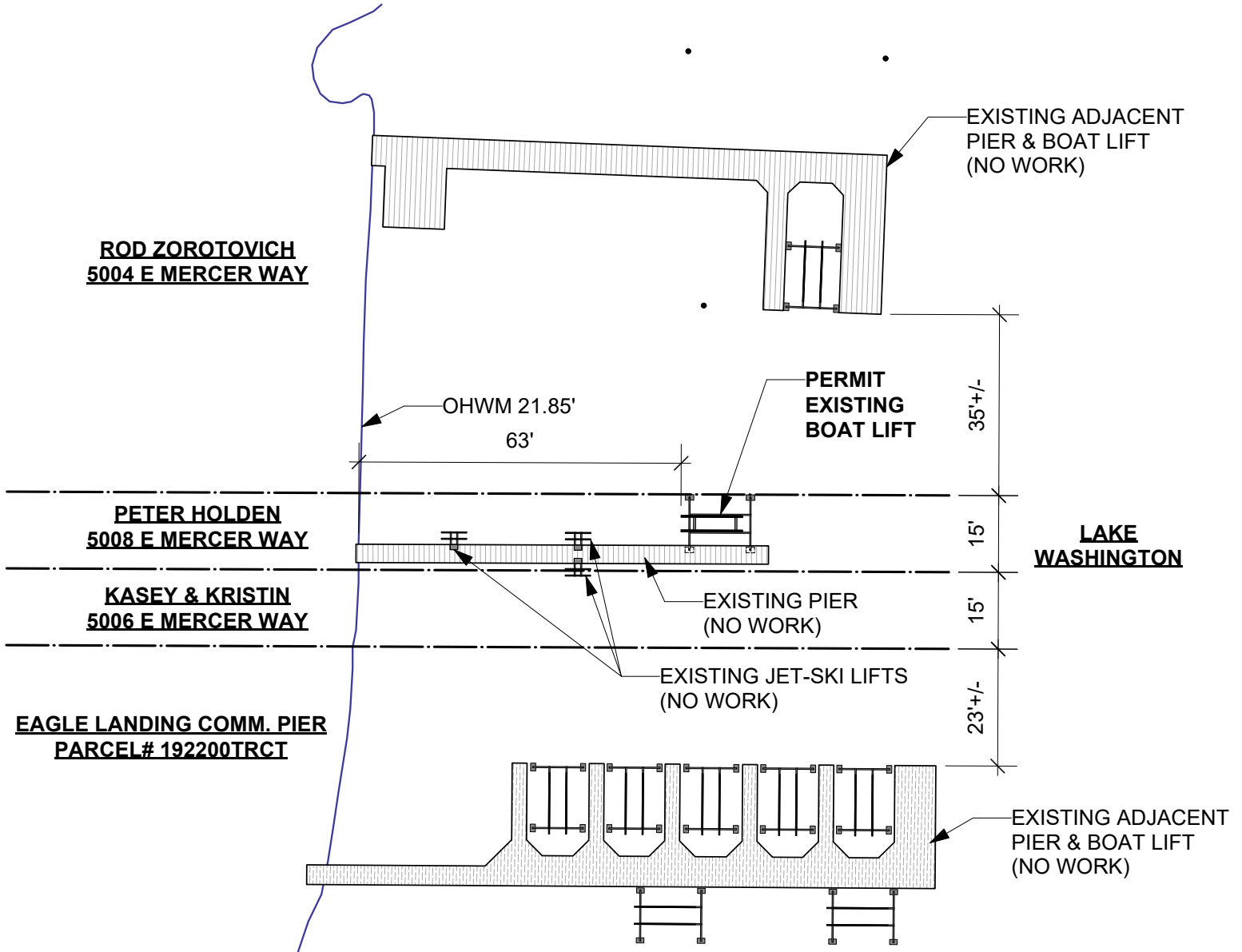

SITE PLAN

SCALE 1" = 30'-0"



Reference:
Applicant: Peter Holden

Proposed: Boat Lift
Location: Mercer Island, WA

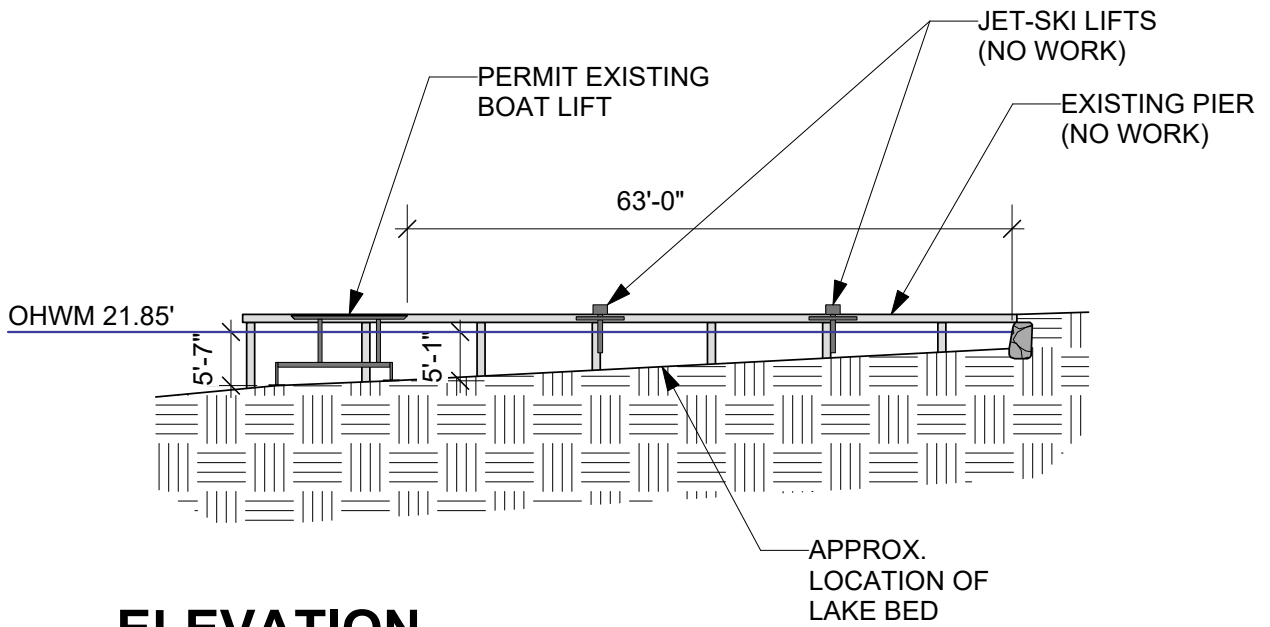

ELEVATION



SCALE 1" = 20'-0"



Reference:
Applicant: Peter Holden

Proposed: Boat Lift
Location: Mercer Island, WA

PLANTING LEGEND

-  SNOWBERRY (2 TOTAL)
-  RED-FLOWERING CURRANT (3 TOTAL)

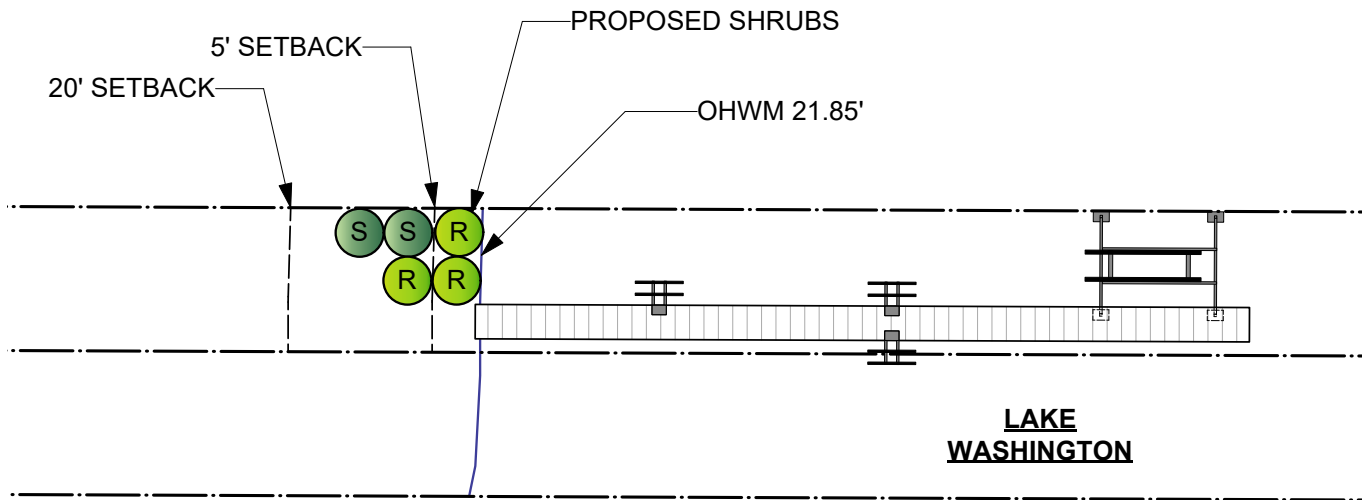

PLANTING COVERAGE CALCULATIONS

NATIVE PLANT COVERAGE WITHIN THE 5' SETBACK = 52%

PLANT COVERAGE WITHIN THE 20' SETBACK = 33%



PLANTING PLAN

SCALE 1" = 20'-0"



Reference:
Applicant: Peter Holden

Proposed: Boat Lift
Location: Mercer Island, WA

Sheet 4 of 4 **Date:** 3/19/2026